

尺寸 Size: 120mm × 120mm × 38mm
 风量 Airflow: 78~112CFM
 重量 Weight: 490g
 噪音 Noise: 35~44dB(A)
 风叶 Impeller Material: PBT UL94~V0 Reinforced Plastic
 外框 Frame: Aluminum Alloy
 端子 Terminals: 0.5mm
 引线 Lead Wire: AWG#22 UL 1569(Optional)
 马达 Motor: Shaded Pole Induction Motor
 温度范围 Operating Temperature: -10°C~+65°C

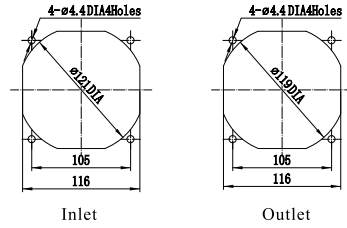

产品型号 Model	轴承型式 Bearing System	电压 Voltage VAC	频率 Freq. Hz	电流 Current A	功率 Power W	转速 Speed RPM	噪音 Noise dB(A)	风量 Air Flow CFM	相数 Phase	电容 Capacitor μF/VAC
G12038HA,S-7P	Sleeve	100/125	50/60	0.30	31/23	2600/3000	39/44	99/112	1	/
G12038HA,S-7P		200/240	50/60	0.18/0.15	25/26	2600/3000	39/44	99/112	1	/
G12038HA,B-7P	Ball	100/125	50/60	0.30	29/24	2600/3000	39/44	99/112	1	/
G12038HA,B-7P		200/240	50/60	0.18/0.15	25/26	2600/3000	39/44	99/112	1	/
G12038MA,S-7P	Sleeve	100/125	50/60	0.25	19/17	2450/2700	38/42	91/100	1	/
G12038MA,S-7P		200/240	50/60	0.16	16/15	2450/2700	38/42	91/100	1	/
G12038MA,B-7P	Ball	100/125	50/60	0.25	19/17	2450/2700	39/42	91/100	1	/
G12038MA,B-7P		200/240	50/60	0.16	16/15	2450/2700	39/42	91/100	1	/
G12038LA,S-7P	Sleeve	100/125	50/60	0.20	14/13	2100/2400	35/40	78/91	1	/
G12038LA,S-7P		200/240	50/60	0.10	12/11	2100/2450	35/40	78/91	1	/
G12038LA,B-7P	Ball	100/125	50/60	0.20	14/13	2100/2450	35/38	78/91	1	/
G12038LA,B-7P		200/240	50/60	0.10	12/11	2100/2450	35/38	78/91	1	/

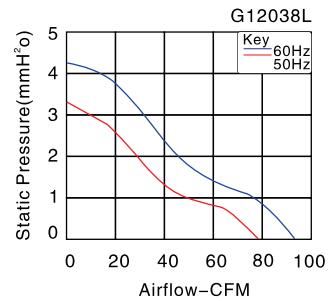
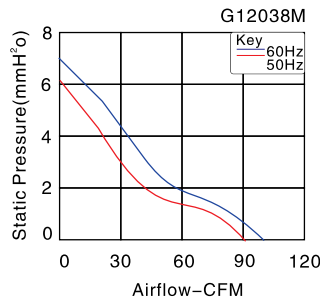
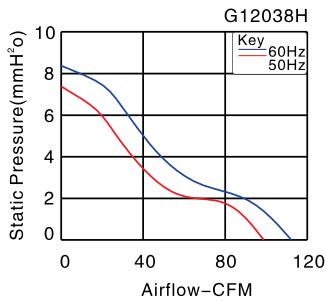

Fan Accessories

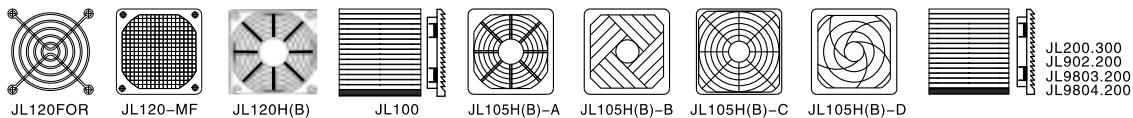

本样册仅供参考，具体以规格书为准。
 This sample book is for reference only, please refer to the specification for details.
 如蒙特殊电压也可根据洽询提供，本公司保留技术改动的权利。
 Special voltage may be provided if necessary, according to the inquiry. Julong all technical modification rights reserved.

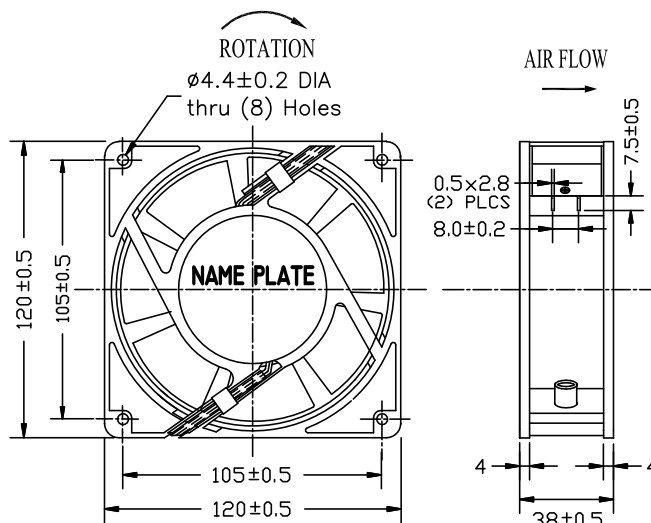

尺寸 Size: 120mm × 120mm × 38mm
 风量 Airflow: 93-126CFM
 重量 Weight: 510g
 噪音 Noise: 43-50dB(A)
 风叶 Impeller Material: PBT UL94-V0 Reinforced Plastic
 外框 Frame: Aluminum Alloy
 端子 Terminals: 0.5mm
 引线 Lead Wire: AWG#22 UL 1569(Optional)
 马达 Motor: Capacitor-Run Induction Motor
 温度范围 Operating Temperature: -10°C~+65°C

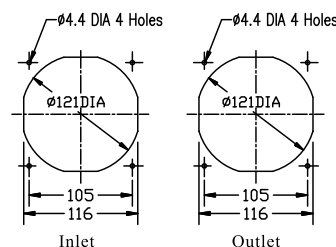

产品型号 Model	轴承型式 Bearing System	电压 Voltage VAC	频率 Freq. Hz	电流 Current A	功率 Power W	转速 Speed RPM	噪音 Noise dB(A)	风量 Air Flow CFM	相数 Phase	电容 Capacitor μF/VAC
G12038HA,S-C-7P	Sleeve	100/125	50/60	0.17/0.18	24/23	2700/3200	46/50	100/119	1	3.3/250
G12038HA,S-C-7P		200/240	50/60	0.10/0.11	21/21	2700/3200	46/50	100/119	1	0.47/500
G12038HA,B-C-7P	Ball	100/125	50/60	0.17/0.18	23/22	2850/3400	45/49	105/126	1	3.3/250
G12038HA,B-C-7P		200/240	50/60	0.10/0.11	20/20	2850/3400	45/49	105/126	1	0.47/500
G12038MA,S-C-7P	Sleeve	100/125	50/60	0.15/0.16	14/14	2550/2800	43/46	93/105	1	3.3/250
G12038MA,S-C-7P		200/240	50/60	0.08/0.09	13/14	2550/2800	43/46	93/105	1	0.47/500
G12038MA,B-C-7P	Ball	100/125	50/60	0.15/0.16	14/14	2550/2800	43/46	93/105	1	3.3/500
G12038MA,B-C-7P		200/240	50/60	0.08/0.09	13/14	2550/2800	43/46	93/105	1	0.47/500

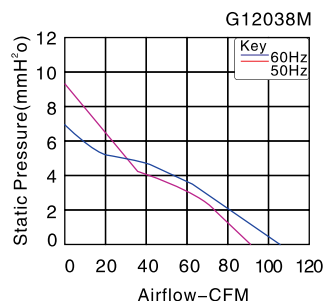
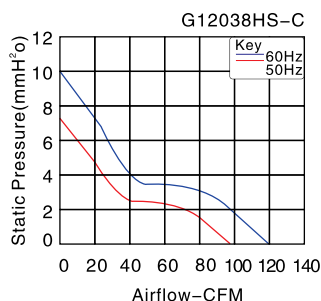
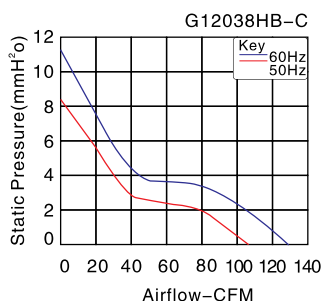

Fan Accessories

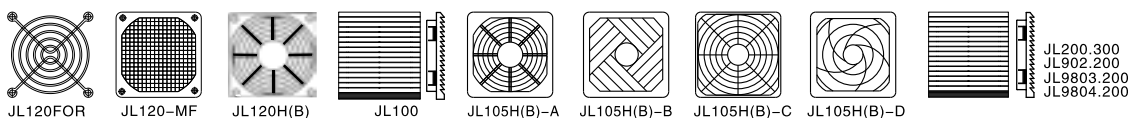

AC Axial Fan
AC轴流风机

AC All-Metal Axial Fan
AC全金属轴流风扇

DC Axial Fan
DC轴流风机

DC Centrifugal Fan
DC离心风机

EC Axial Fan
EC轴流风机

EC Centrifugal Fan
EC离心风机

AC Centrifugal Fan
AC离心风机

Fan Accessories
风机配件