

The information provided herein is from CONNFLY Electronic Co., Ltd. and is confidential. Any disclosure to a party other than the recipient is prohibited. The intellectual properties and its rights contained herein, including but not limited to, trademarks, patents, copyrights, trade secrets, and technical know-how, are owned exclusively by CONNFLY or its affiliates. Unauthorized use or modification is strictly prohibited. CONNFLY may enforce its intellectual property rights at its own discretion; failures or delays to exercise such rights does not constitute a waiver of such rights.

1 2 3 4 5 6 7 8

Dept	Qty
DC	1
ED	1
IE	1
ISO	1
PD	1
R&D	1
SD	1
QA	1
QC	1
QE	1

REV.	DESCRIPTION	DRAWN	CHECKED	APPROVED
A	NEW RELEASE	HP 29/06/05		LJC 29/06/05
B	ADD P/N CODE	JLZ 01/30/15'		LJC 01/30/15'
C	DRAWING UPDATE	JLZ 12/27/16'		
D	DRAWING UPDATE	JLZ 07/18/18'		

Female Terminal

T-DS1073- S C 6 0 0
 Contact Plating
 6: Tin

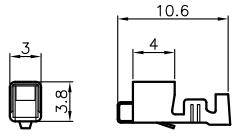

Female Terminal

Wire Range		O.D of Wire
Section area mm ²	AWG#	mm
0.33~0.83	22~18	1.7~3.0

NOTES:

- MAIN SPECIFICATIONS
 - Housing material: NYLON 66
 - Wire range: AWG#22~#18
 - Rated voltage: 250V
 - Rated current: 7A
 - Contact resistance: ≤ 30mΩ
 - Insulation resistance: ≥ 1000MΩ
 - Withstanding voltage: 1000V, AC 1 minute
 - Temperature range: -25 ~ +85°C
 - Recommend PC board thickness: 1.6mm

Female Housing

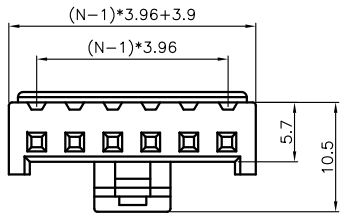

I-DS1073-S C W 0 X
 No. of contact
 02~13

2. PRODUCT NUMBER CODE:

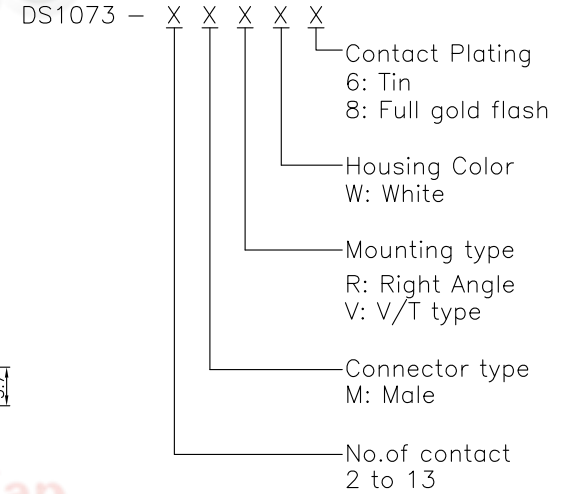

N=No. of contacts

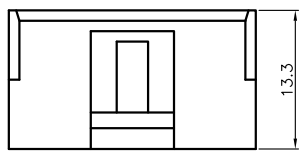

Right Angle

V/T Type

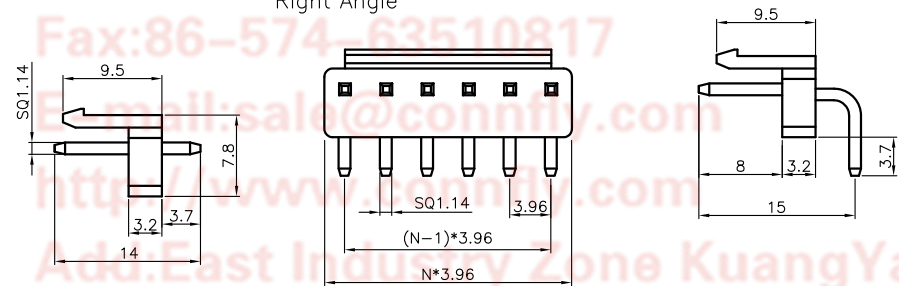
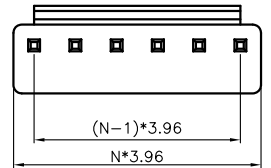

N=No. of contacts

Tel:86-574-63508787
 Fax:86-574-63510817
 E-mail:sale@connfly.com
 http://www.connfly.com
 Add:East Industry Zone KuangYan
 Town Cixi Ningbo China
 P.C:315333

GENERAL TOLERANCE	ANGLE TOLERANCE	PROJECTION		TITLE	P.C.B CONNECTOR 3.96mm VH
		UNITS	mm		
X ±0.60	X ±5°	SHEET SIZE	A4	SERIES	DS1073 SERIES
.X ±0.38	.X ±3°	晨翔电子有限公司 CONNFLY CONNFLY ELECTRONIC CO. LTD			
.XX ±0.25	.XX ±2°				
DRAWING TYPE	CUSTOMER				
SCALE	1:1	SHEET	1 OF 1		
DRAWING NO.	C-DS1073-XXXXX-D				

1 2 3 4 5 6 7 8